

Build Your Own Bar System

Walk-Up Wall Bars, Standard

Note: If matching with a Front Bar, subtract 16" from the width of the Front Bar, or 8" from a Flush-Cut Front Bar to find the width of the Walk Up Wall Bar.

1. Select Desired Style:



MAR
Marin



NAP
Napa



RUT
Rutherford

2. Select Desired Size & Options:

Cabinet Options

The line drawings to the left show letters inside circles indicating cabinet positions. If you would like one of the options shown below in the space marked with that letter, please write the letter in the circle beneath the pictured option. Note: Adjustable shelf is standard.

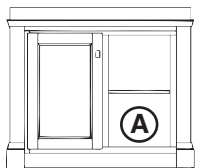

44"
 50"

OPTIONS: A Cabinet



56"
 62"
 68"
 74"

OPTIONS: A Cabinet

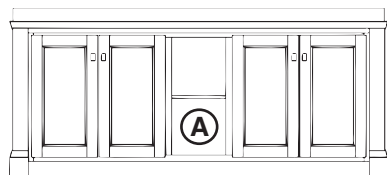

80"
 86"
 92"
 98"

OPTIONS: A Cabinet

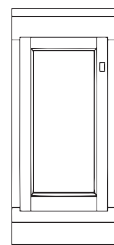

Non-Locking Door

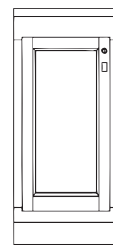
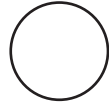

Locking Door

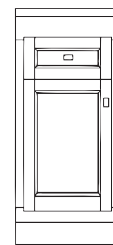
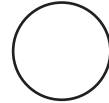

Drawer Over Door

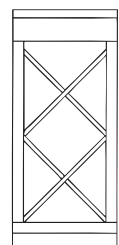
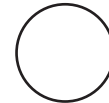

X-Style Wine Rack

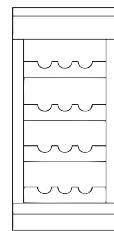
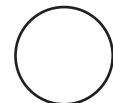

Bottle Cradle Rack

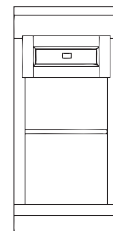
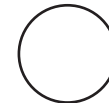

Drawer Over X-Rack

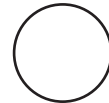

3. Select Height

Other Options:

Black Laminate Counter Top

Raised Panels (N/A Rutherford)

4. Specify Finish:

Wood Finish Color: _____

Your Store Name: _____ City, State: _____

Purchase Order Number: _____ Sidemark: _____